

MS7422-F Series

2.0MP Mini Ultra WDR & Starlight Speed Dome Camera



Features

Excellent Image Quality

- 2.0 Megapixel 1/1.8" progressive scan CMOS sensor
- High definition and smooth picture, 1920 x 1080@30fps
- H.265 video codec, saves up to 50% bandwidth and storage
- Ultra low illumination, 0.001lux with color picture
- IR automatically adjusts
- WDR / 3D noise reduction / HLC / BLC

Intelligent Functions

- Motion detection / Tampering / Guard line / Enter guard area / Exit guard area / Object left / Object removal / Gathering / Audio surge

Long Operation Lifespan

- Industrial components, withstands operation temperatures of -40°C ~ 70°C
- IP67, TVS 6000V lightning protection, surge protection and voltage transient protection

Large Scale

- 12x optical zoom (-F112)
- 5x optical zoom (-F105)
- IR distance up to 50m

Abundant Functions and Features

- Micro SD card optional, supports Automatic Network Replenishment (ANR)
- Up to 3 Multi-stream
- Bi-directional audio / alarm in and out
- Built-in O-sensor
- PoE (-F105-NP / -F112-NP)
- IK10
- IP67

Dimensions

Units: mm

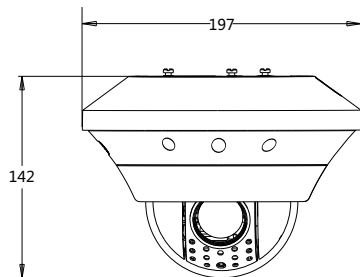

Specifications

	MS7422-F105-N	MS7422-F105-NP	MS7422-F112-N	MS7422-F112-NP
Camera				
Image Sensor	1/1.8" progressive scan CMOS			
Pixels	2.0 Megapixel			
Min. Illumination	Color: 0.001lux @ (F1.6, AGC ON) B/W: 0.0001lux @ (F1.6, AGC ON); 0lux with IR			
Shutter Speed	1 ~ 1/30,000s			
Day / Night	Auto (ICR) / Color / B/W			
Wide Dynamic Range	Ultra WDR, >=120dB			
S/N Ratio	>57dB			
White Balance	Auto / Manual			
Gain Control	Auto / Manual			
Backlight Compensation	Off / WDR / BLC / HLC			
Lens				
Focal Length	2.7 ~ 13.5mm, 5x optical		5.3 ~ 63.6mm, 12x optical	
Zoom Speed	Approx 3s (Optical)			
Angle of View	113.06° ~ 30.61° (Wide~Tele)		58.2° ~ 4.83° (Wide~Tele)	
Min. Object Distance	10 ~ 1500mm (Wide~Tele)			
Max. Aperture Ratio	F1.6 ~ F2.8			
Focus Control	Auto / Manual / Semi-Automatic			
Infrared				
IR LED	4 pcs IR LED Array			
IR Distance	30m		50m	
IR Intensity	Automatically adjust according to zoom ratio			
Pan and Tilt				
Pan / Tilt Range	360° Endless / -15° ~ 90° (Auto Flip)			
Pan / Tilt Speed	Pan manual speed: 0.1° ~ 220°/s; Pan preset speed: 220°/s Tilt manual speed: 0.1° ~ 160°/s; Tilt preset speed: 160°/s			
Proportional Zoom	Pan / Tilt speed can be adjusted automatically according to zoom multiples			
Preset	256			
Patrol	8 Patrols scheme, up to 32 presets per patrol			
Pattern Scan	4 Scan paths, each path can record 10 minutes of operation path			
Power-off Memory	Power-off memory / Power-on recovery			
Auto Guard	Path / Preset / Mixed / Pan scan / Tilt scan / Frame scan / Random scan / Panorama scan			
PT Limit	Manual / Scan / Pan			
3D Positioning	PTZ control with mouse click and drag			
Electronic compass	Built-in O-sensor			
Video				
Compression	H.265 / H.264 / MJPEG			
Image Resolution	Main stream: 1080p Secondary stream: D1			
Frame Rate	Main stream: 1080p@30fps Secondary stream: D1@30fps			
Bitrate	32~16384kbps			
Bitrate Control	VBR / CBR			
Multi-stream	Supported			
Caption	Date and time / Alarm / Direction / Customized			
Privacy Masking	Up to 4 zones			
Motion Detection	Up to 4 zones			
Video Freeze	Supported			
ROI	Supported			
Digital Noise Reduction	3D noise reduction			
Digital Defog	Supported			
Image Flip	Flip / Mirror			
Audio				
Compression	G.711a / G.711u / ADPCM / G.722 / AAC-LC / G.722.1c / G.726			
Bitrate	32kbps ~ 64kbps			
Audio Function	Bi-directional audio / AEC / Mixed audio recording / Dumb / Mute			
Network				
Network Protocols	TCP/IP, UDP, HTTP, DHCP, DNS/DDNS, RTP/RTCP, RTSP, PPPoE, FTP, VSIP, UPnP, 802.1x, NAT, QoS, SMTP, IPv4, IPv6 (optional)			
User Interface	IPC Control (IE, Firefox, Chrome)			
Max. User Access	Max. 10 Users (includes 2 internal)			
Application Programming	ONVIF (Profile S, Profile G), GB/T 28181-2011, API, CGI			
Automatic Network Replenishment (ANR)	Supported			
Alarm				
Alarm Triggers	Alarm input / Network disconnect / Disk full / Disk error			
Intelligent	Motion detection / Tampering / Guard line / Enter guard area / Exit guard area / Object left / Object removal / Gathering / Audio surge			
Alarm Events	Alarm report / Recording / Text overlay / Snapshot / External output / Email notice / Acoustic alarm			
Interfaces				
Ethernet	10/100M, RJ45 interface			
Audio In / Out	1 x Line in / 1 x Line out			
Control	1 x Input / 1 x Output			
Alarm In / Out	1 x BNC, 1.0V [p-p] / 75Ω			
Video Out	Built-in SD card (optional), supports up to 256GB			
Memory Slot	SD card slot, supports up to 128GB			
Environmental				
Operating Temperature	-40°C ~ 70°C / -40°F ~ 158°F			
Operating Humidity	10% ~ 95%			
Protection Level	IK10, IP67, TVS 6000V lightning protection, surge protection and voltage transient protection			
Electrical				
Power	12V DC ± 25% (Power Adapter Not Included)	12V DC ± 25% / PoE (IEEE802.3af)	12V DC ± 25% (Power Adapter Not Included)	12V DC ± 25% / PoE (IEEE802.3af)
Power Consumption	Max. 30W (IR on)			
Mechanical				
Weight	2 kg / 4.4lb (Gross Weight)			
Dimensions	Φ197 × 142mm / Φ7.76" × 5.59"			